

Controlled by
NX100

The MOTOMAN EPX-series are versatile, high-speed 6 axis robots offering superior performance in painting applications for car bodies, plastic components and work pieces of different sizes.

These robots feature a hollow wrist, which reduces cycle times and offers optimum accessibility.

Furthermore, whilst the working envelope is relatively large, the installation only requires little space.

In a smooth workflow even and smooth surfaces are produced with high speed and unique efficiency.



- *Versatile, fast and flexible*
- *Perfect accessibility*
- *Large working range*
- *Variable payload*
- *Unique efficiency*

MOTOMAN EPX-series

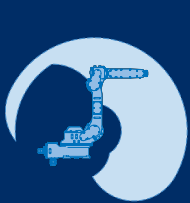

EPX1250

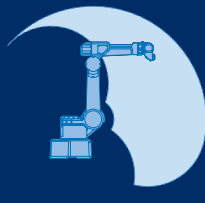

EPX2050

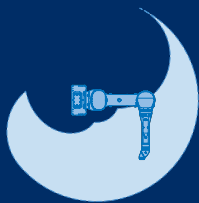

EPX2700

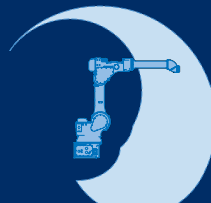

EPX2800

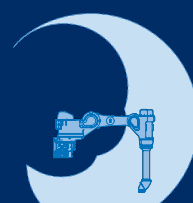

EPX2800R

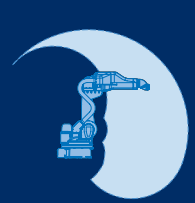

EPX2900

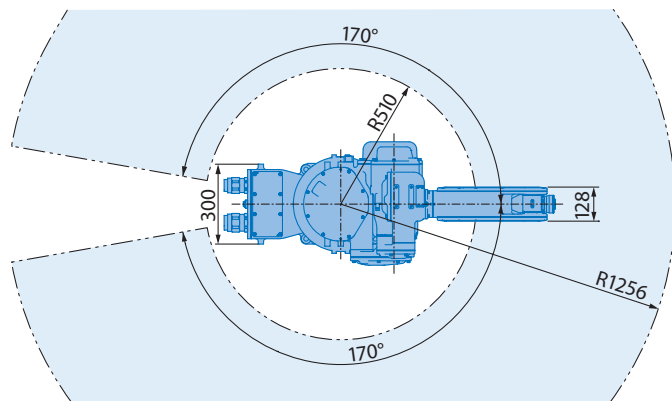
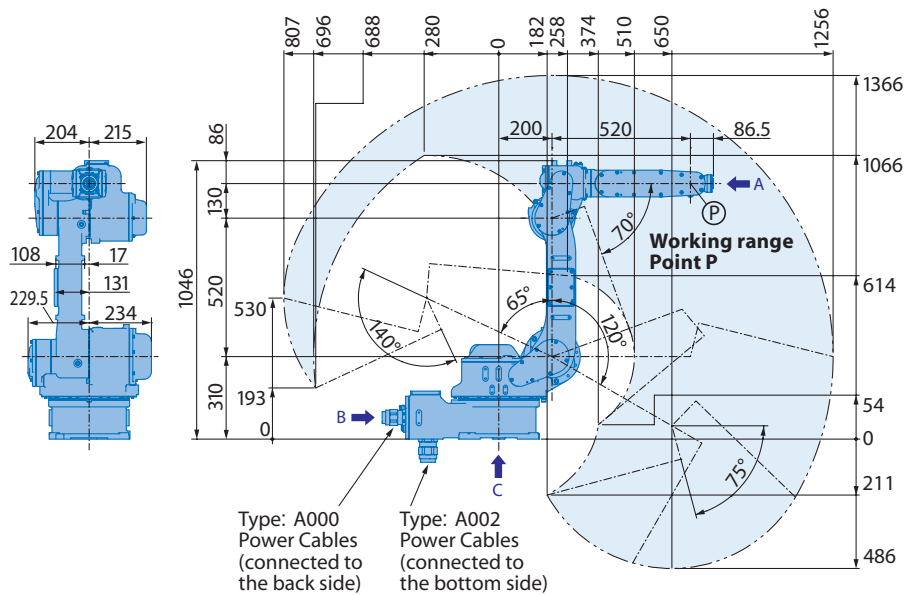

View A

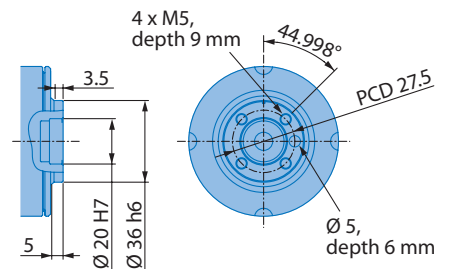

View B

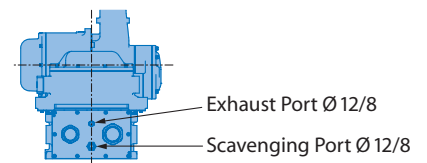

View C

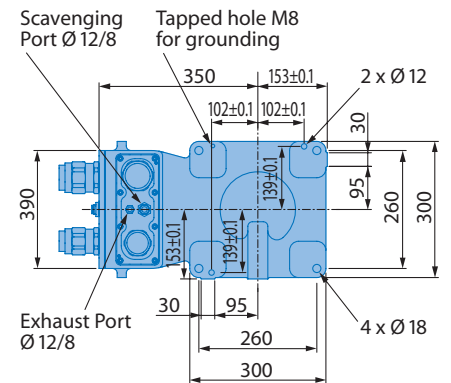

Mounting option: Floor, ceiling, wall

All dimensions in mm | Technical data may be subject to change without previous notice | Please request detailed drawings at robotics@yaskawa.eu.com – C-04-2014, A-No. 156797



Protection level:
 II2G Ex px IIC T4 Gb
 II2D Ex p IIIC T135°C Db IP66
 0408

Specifications EPX1250

Axes	Maximum motion range [°]	Maximum speed [°/sec.]	Allowable moment [Nm]	Allowable moment of inertia [kg · m ²]	Controlled axes	
S	±170	185	-	-	Max. payload [kg]	6
L	+120/-65	185	-	-	Repeat. pos. accuracy [mm]	5
U	+205/-165	185	-	-	Max. working range [mm]	±0.15
R	±190	360	8	0.20	Temperature [°C]	R = 1256
B	±145	410	8	0.20	Humidity [%]	0 to +40
T	±360	500	3	0.07	Weight [kg]	20 – 80
					Power supply, average [KVA]	110
						1.5

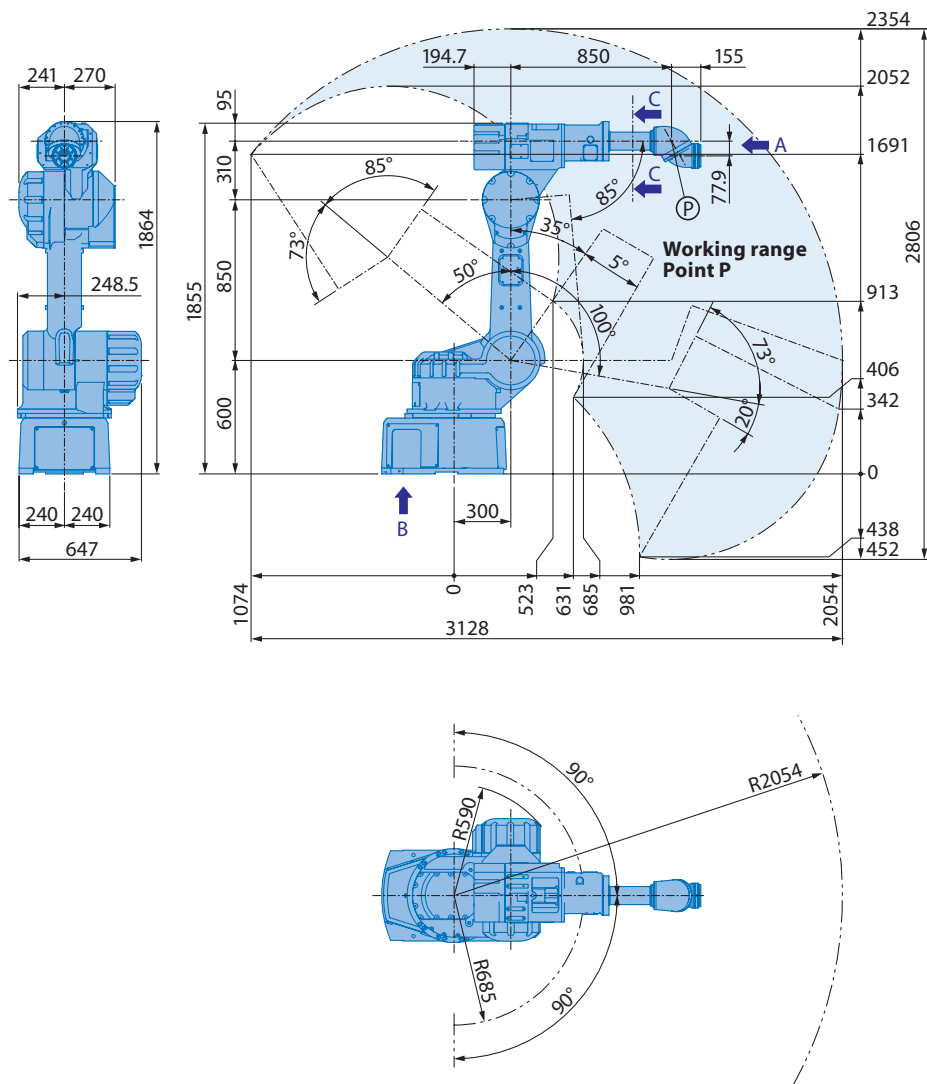

View A

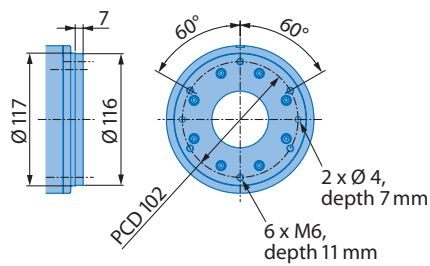

View B

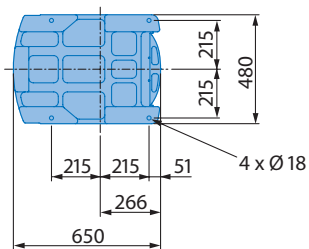

View C

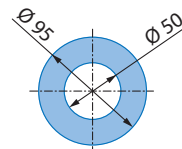

Mounting option: Floor

Protection level:
 Ex II 2G Ex px II T4
 II 2D Ex pD 21 IP66 Tmax 135°C
 CE 0408

All dimensions in mm | Technical data may be subject to change without previous notice | Please request detailed drawings at robotics@yaskawa.eu.com – C-04-2014, A-No. 156797

Specifications EPX2050

Axes	Maximum motion range [°]	Maximum speed [m/sec.]	Allowable moment [Nm]	Allowable moment of inertia [kg · m ²]	Controlled axes	
S	±90	2	-	-	Max. payload [kg]	6
L	+100/-50	is composite speed of all axis	-	-	Repeat. pos. accuracy [mm]	15
U	+5/-163		-	-	Max. working range [mm]	±0.5
R	±360	45.8	1.45	Temperature [°C]	0 to +45	
B	±360	33.8	0.79	Humidity [%]	20 – 80	
T	±360	10.8	0.10	Weight [kg]	540	
				Power supply, average [KVA]	5	



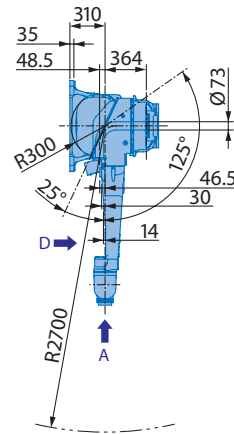
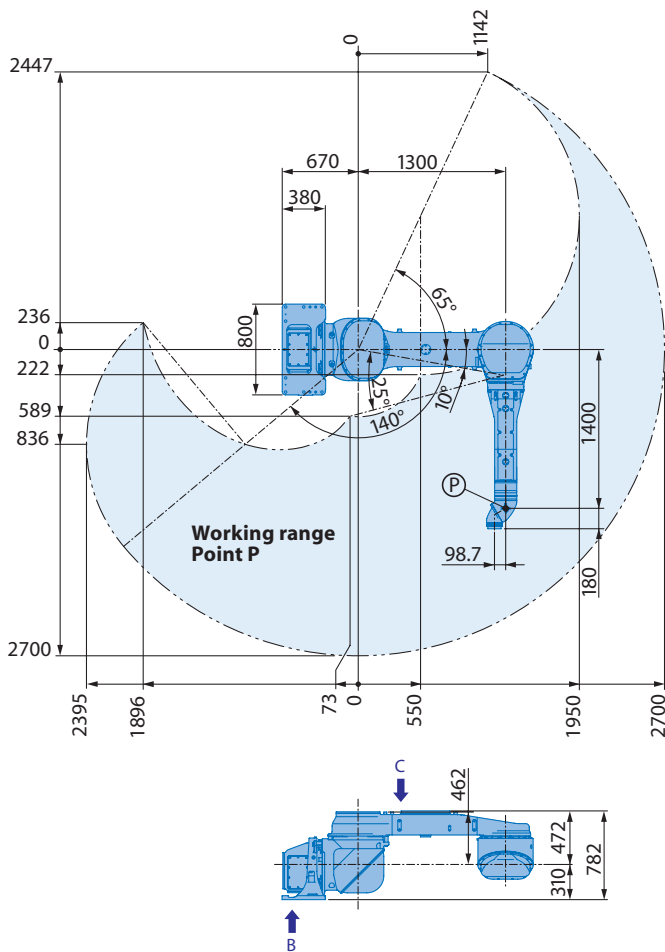

View A

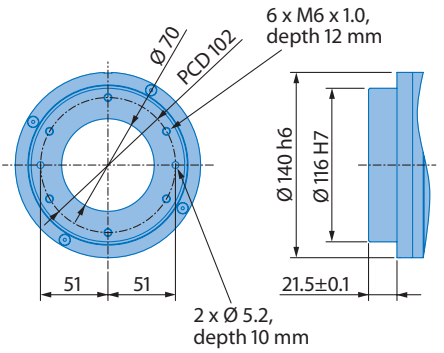

View B

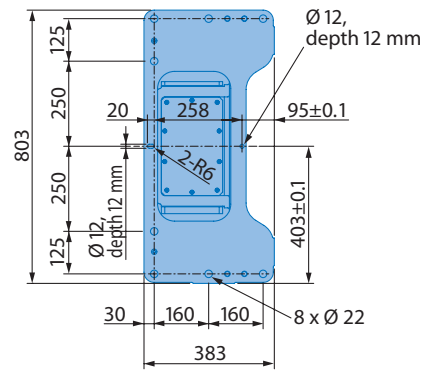

View C

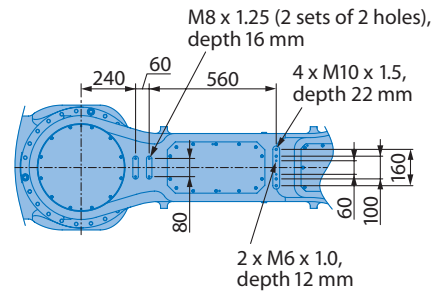

Mounting option: Wall

View D

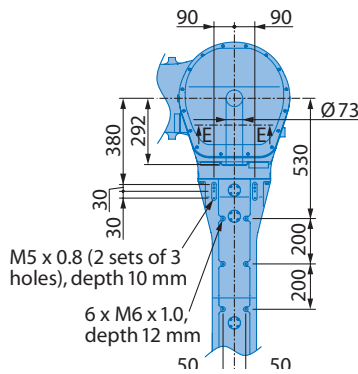

Protection level:

II2G Ex px IIC T4 Gb
II2D Ex p IIIC T135°C Db IP66



0408



All dimensions in mm | Technical data may be subject to change without previous notice | Please request detailed drawings at robotics@yaskawa.eu.com – C-04-2014, A-No. 156797

Specifications EPX2700

Axes	Maximum motion range [°]	Maximum speed [m/sec.]	Allowable moment [Nm]	Allowable moment of inertia [kg · m ²]	Controlled axes	
S	+125/-25	2	-	-	Max. payload [kg]	6
L	+140/-65	is composite	-	-	Repeat. pos. accuracy [mm]	15
U	+90/-65	speed	-	-	Max. working range [mm]	±0.15
R	±720	of all axis	45.8	1.45	Temperature [°C]	R = 2700
B	±720		33.8	0.79	Humidity [%]	0 to +40
T	±720		10.8	0.10	Weight [kg]	20 – 80
					Power supply, average [KVA]	590
						5

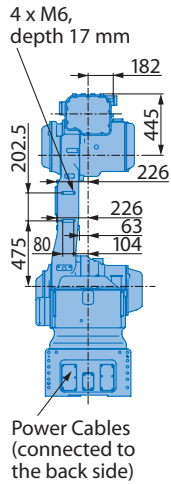
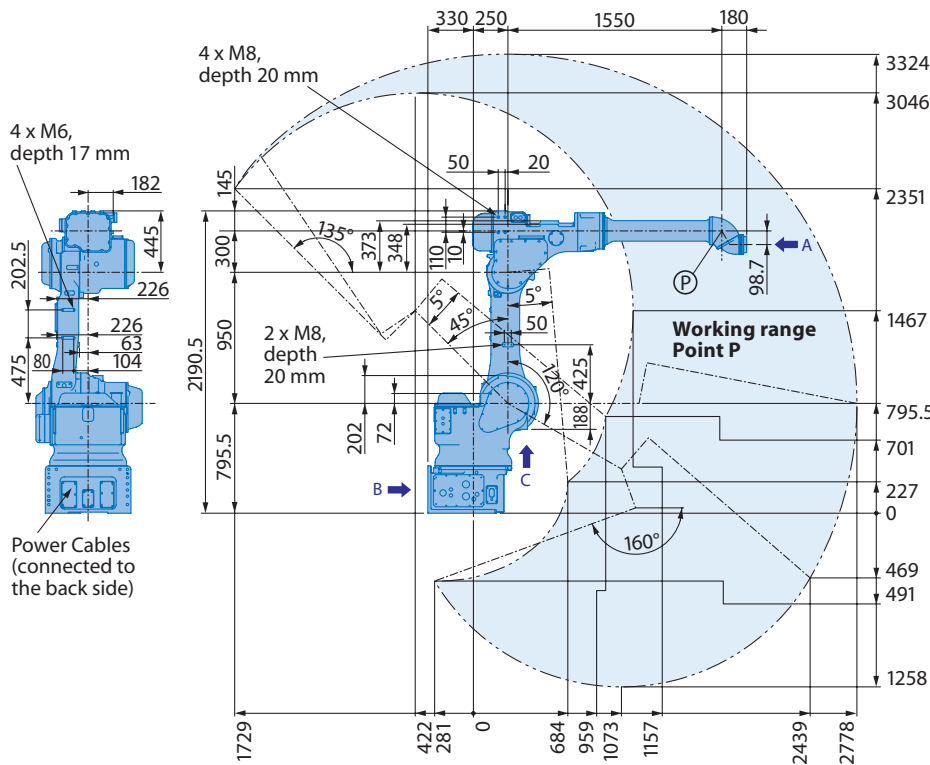

Power Cables (connected to the back side)

View A

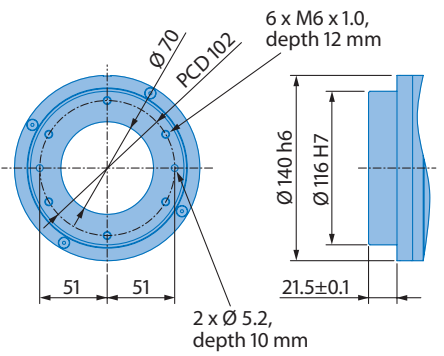

View B

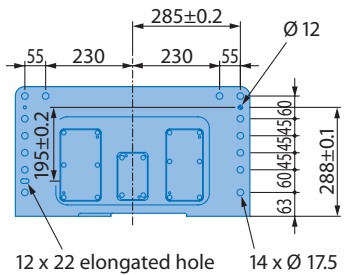

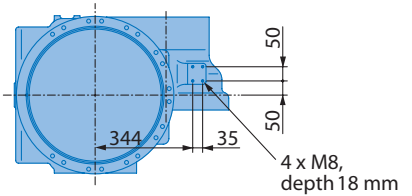

View C

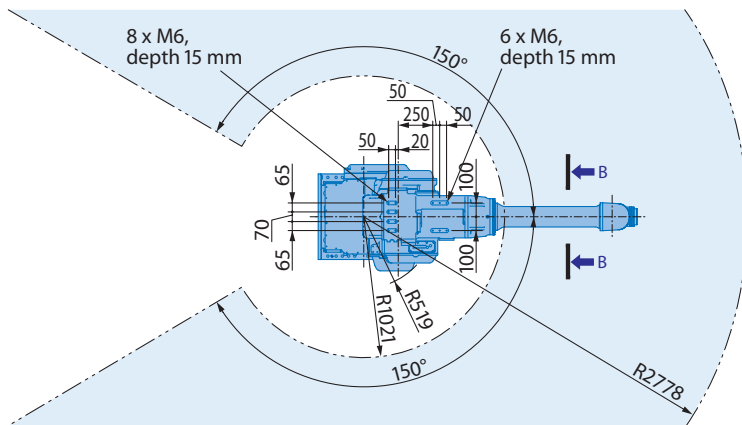

Mounting option: Floor



Protection level:
 II2G Ex px IIC T4 Gb
 II2D Ex p IIIC T135°C Db IP66

 0408



All dimensions in mm | Technical data may be subject to change without previous notice | Please request detailed drawings at robotics@yaskawa.eu.com – C-04-2014, A-No. 156797

Specifications EPX2800

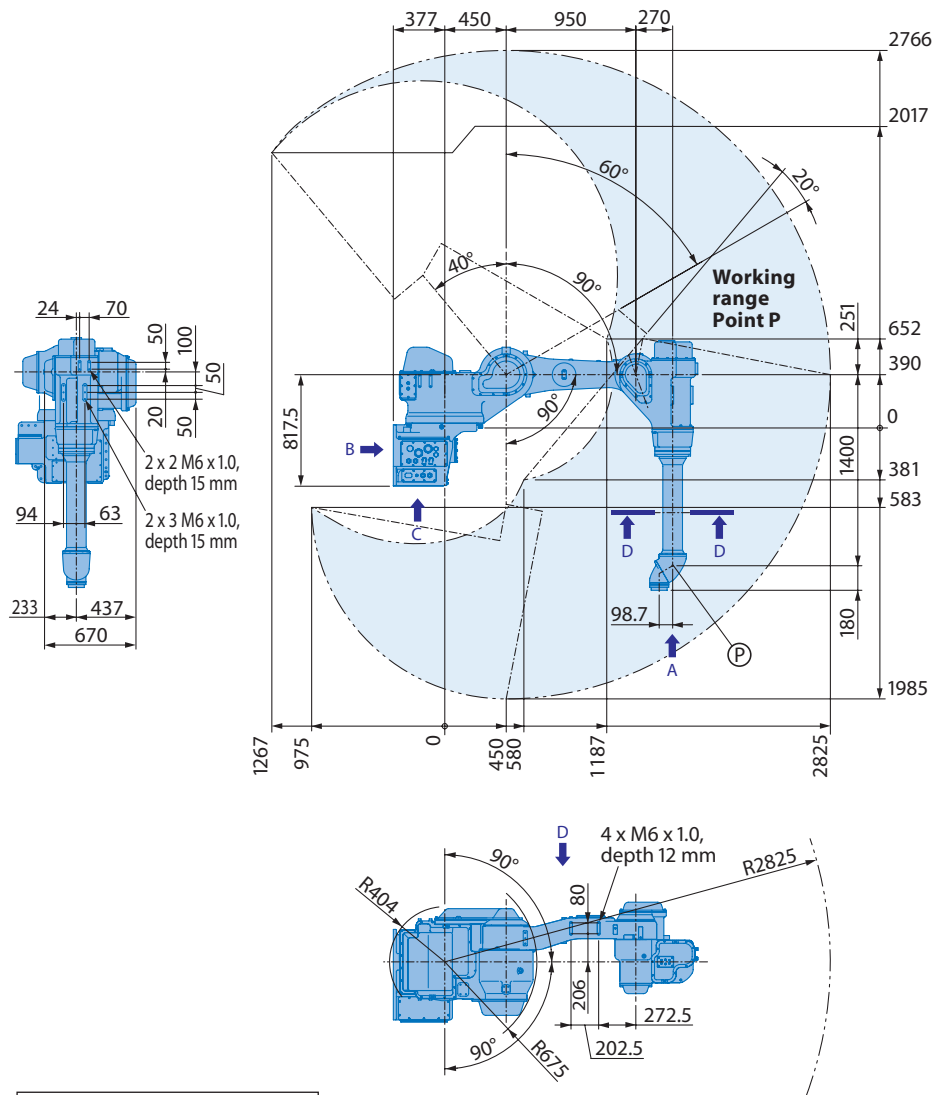
Axes	Maximum motion range [°]	Maximum speed [m/sec.]	Allowable moment [Nm]	Allowable moment of inertia [kg · m ²]	Controlled axes	
S	±150	2	-	-	Max. payload [kg]	6
L	+120/-45	is composite speed of all axis	-	-	Repeat. pos. accuracy [mm]	20
U	+90/-85		-	-	Max. working range [mm]	±0.5
R	±360		77.4	2.45	Temperature [°C]	R = 2778
B	±360	49.9	1.20	Humidity [%]	0 to +40	
T	±360	16.6	0.20	Weight [kg]	20 – 80	
				Power supply, average [KVA]	650	
					5	



View A

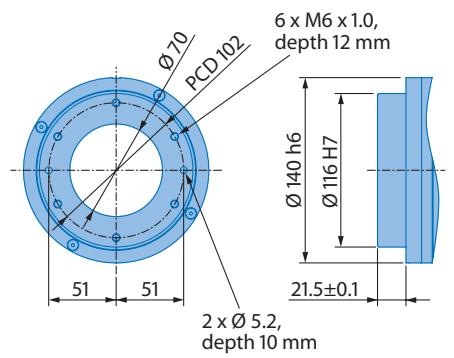

View B

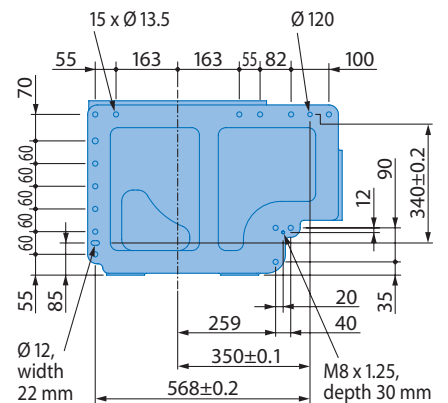

View C

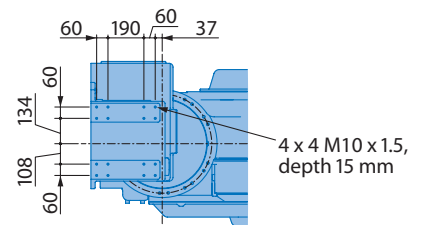

Mounting option: Wall

Protection level:

Ex II2G Ex px II T4
II2D Ex pD 21 Tmax 135°C



View D

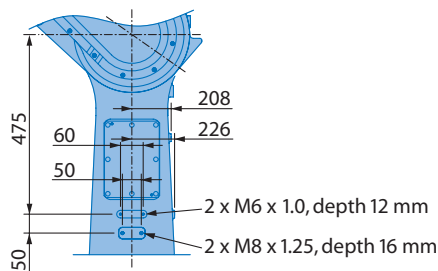

All dimensions in mm | Technical data may be subject to change without previous notice | Please request detailed drawings at robotics@yaskawa.eu.com – C-04-2014, A-No. 156797

Specifications EPX2800R

Axes	Maximum motion range [°]	Maximum speed [m/sec.]	Allowable moment [Nm]	Allowable moment of inertia [kg · m ²]	Controlled axes	
S	±120	2	-	-	Max. payload [kg]	6
L	+90/-130	is composite speed of all axis	-	-	Repeat. pos. accuracy [mm]	15
U	+90/-70		-	-	Max. working range [mm]	±0.5
R	±360		45.8	1.45	Temperature [°C]	R = 2825
B	±360		33.8	0.79	Humidity [%]	0 to +45
T	±360		10.8	0.10	Weight [kg]	20 – 80
					Power supply, average [KVA]	820
						5

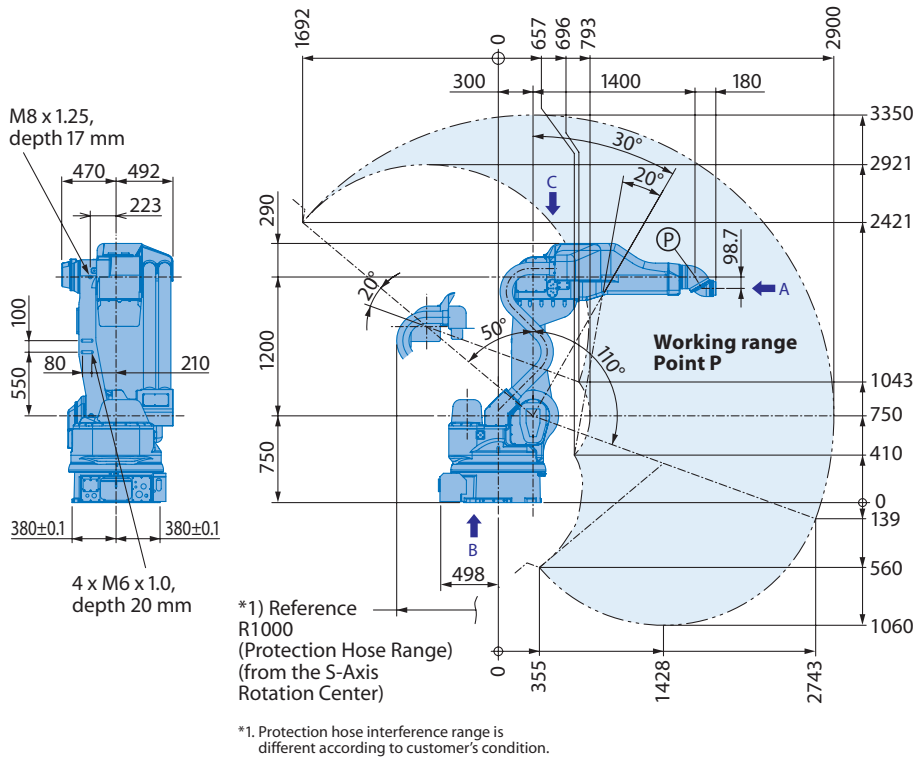

View A

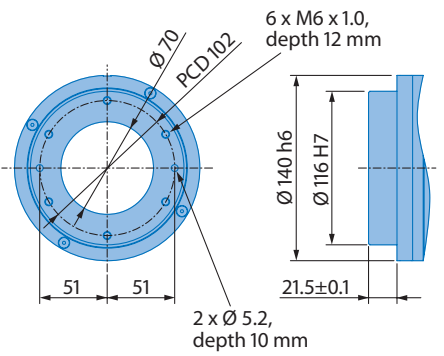

View B

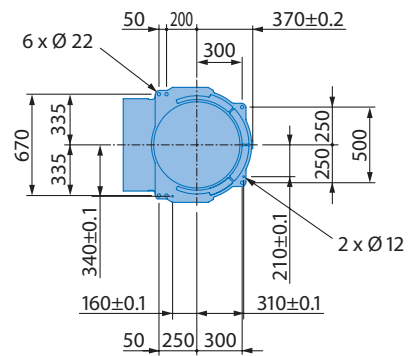

View C

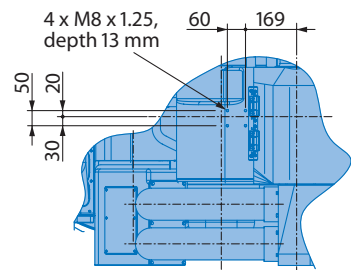

Mounting option: Floor

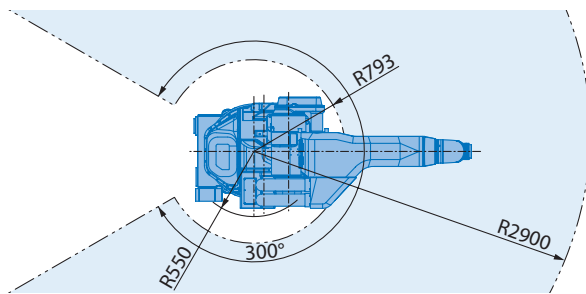

Protection level:

II2G Ex px II T4
II2D Ex pD 21 Tmax 135°C

CE
0408



All dimensions in mm | Technical data may be subject to change without previous notice | Please request detailed drawings at robotics@yaskawa.eu.com – C-04-2014, A-No. 156797

Specifications EPX2900

Axes	Maximum motion range [°]	Maximum speed [°/sec.]	Allowable moment [Nm]	Allowable moment of inertia [kg · m ²]	Controlled axes	
S	±150	155	-	-	Max. payload [kg]	6
L	+110/-50	125	-	-	Repeat. pos. accuracy [mm]	±0.5
U	+90/-70	155	-	-	Max. working range [mm]	R = 2900
R	±360	450	72.0	-	Temperature [°C]	0 to +45
B	±360	550	51.5	-	Humidity [%]	20 – 80
T	±360	650	19.6	-	Weight [kg]	1030
					Power supply, average [KVA]	5

YASKAWA
Headquarters
YASKAWA Europe GmbH
Robotics Division
Yaskawastraße 1
D-85391 Allershausen
Tel. +49 (0) 8166/90-0
Fax +49 (0) 8166/90-103

**YASKAWA academy and
sales office Frankfurt**
YASKAWA Europe GmbH
Robotics Division
Hauptstraße 185
D-65760 Eschborn
Tel. +49 (0) 6196/77725-0
Fax +49 (0) 6196/77725-39

YASKAWA Group

A YASKAWA Austria
Schwechat/Wien +43(0)1-707-9324-15

CZ YASKAWA Czech s.r.o.
Rudná u Prahy +420-257-941-718

E YASKAWA Ibérica, S.L.
Gavà/Barcelona +34-93-6303478

F YASKAWA France SARL
Saint-Aignan-de-Grand-Lieu
+33-2-40131919

FIN YASKAWA Finland Oy
Turku +358-(0)-403000600

GB YASKAWA UK Ltd.
Banbury +44-1295-272755

I YASKAWA Italia s.r.l.
Torino +39-011-9005833

IL YASKAWA Europe Technology Ltd.
Rosh Ha'ayin +972-3-9004114

NL YASKAWA Benelux B.V.
EB Son +31-40-2895500

RUS YASKAWA Nordic AB
Moskva +46-480-417-800

SE YASKAWA Nordic AB
Torsås +46-480-417-800

SI YASKAWA Slovenia
Ribnica +386-1-8372-410

TR YASKAWA Turkey Elektrik Ticaret Ltd. Sti.
İstanbul +90-216-5273450

ZA YASKAWA Southern Africa (PTY) Ltd
Johannesburg +27-11-6083182

Distributors

BG Kammarton Bulgaria Ltd.
Sofia +359-02-926-6060

CH Messer Eutectic Castolin Switzerland S.A.
Dällikon +41-44-847-17-17

DK Robotcenter Danmark
Løsning +45 7022 2477

EE RKR Seadmed OÜ
Tallinn/Estonia +372-68-35-235

GR Gizelis Robotics
Nea Kifissia +30-2106251455

H Flexman Robotics Kft
Budapest +36-30-9510065

LT Profibus UAB
Panevezys +370-45-518575

N Optimove as
Lierstranda +47-32240600

PL Integrator RHC Sp. z o.o.
Torun +48-56-6519710

PT ROBOPLAN Lda
Aveiro +351-234 943 900

RO Sam Robotics srl
Timisoara +40-720-279-866

RO MPL Automation S.R.L.
Satu Mare +40 (0) 261 750 741



www.yaskawa.eu.com
robotics@yaskawa.eu.com

Technical data may be subject to change without previous notice.

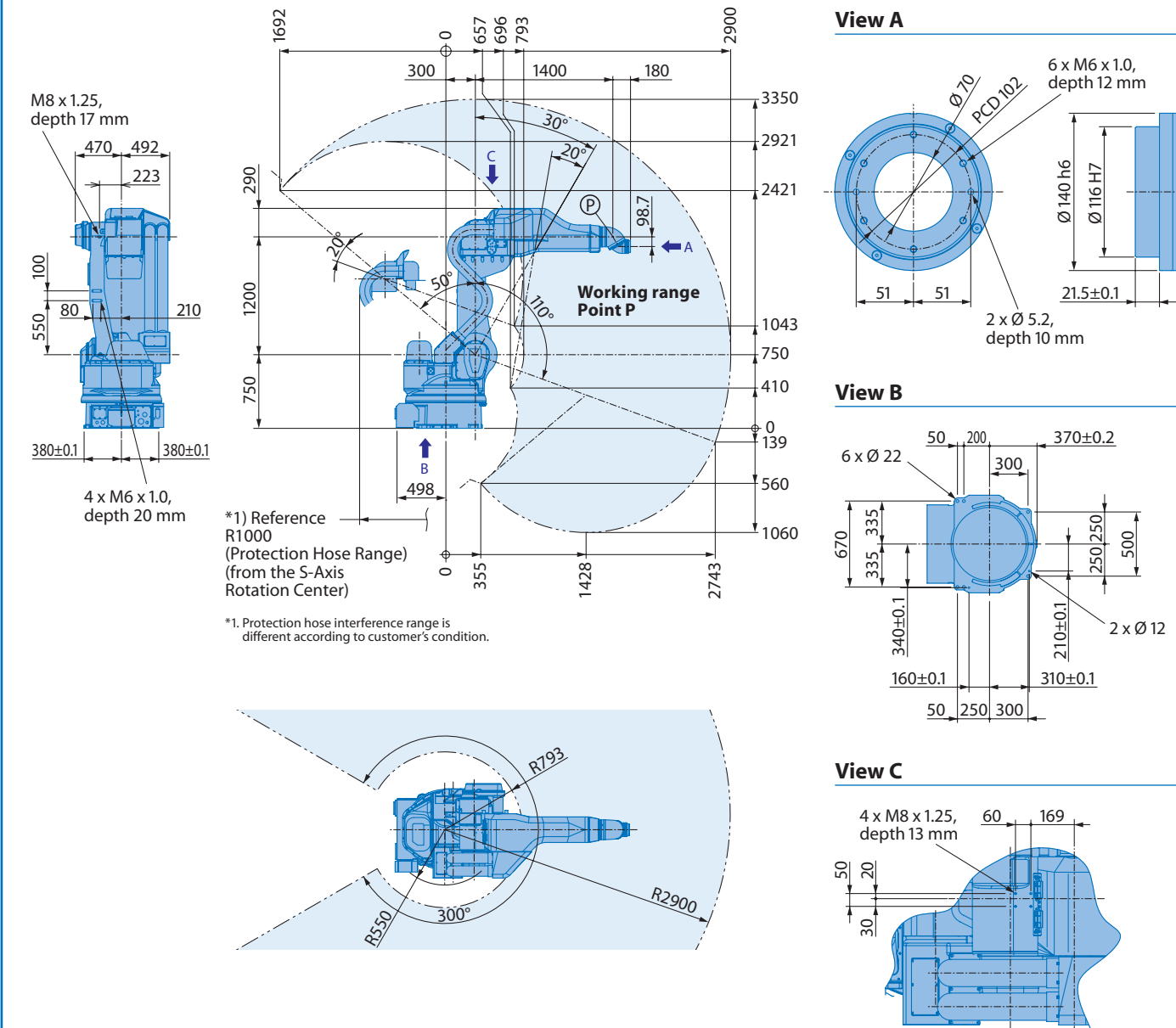

Protection level:
 II2G Ex px II T4
 II2D Ex pD 21 Tmax 135°C
 CE 0408

All dimensions in mm | Technical data may be subject to change without previous notice | Please request detailed drawings at robotics@yaskawa.eu.com - C-04-2014, A-No. 156797

Specifications EPX2900

Axes	Maximum motion range [°]	Maximum speed [°/sec.]	Allowable moment [Nm]	Allowable moment of inertia [kg · m ²]	Controlled axes	
S	±150	155	-	-	6	
L	+110/-50	125	-	-	20	
U	+90/-70	155	-	-	Repeat. pos. accuracy [mm]	±0.5
R	±360	450	72.0	-	Max. working range [mm]	R = 2900
B	±360	550	51.5	-	Temperature [°C]	0 to +45
T	±360	650	19.6	-	Humidity [%]	20 - 80
					Weight [kg]	1030
					Power supply, average [KVA]	5

YASKAWA Group

- A** YASKAWA Austria
Schwechat/Wien +43(0)1-707-9324-15
- CZ** YASKAWA Czech s.r.o.
Rudná u Prahy +420-257-941-718
- E** YASKAWA Ibérica, S.L.
Gavà/Barcelona +34-93-6303478
- F** YASKAWA France SARL
Saint-Aignan-de-Grand-Lieu +33-2-40131919
- FIN** YASKAWA Finland Oy
Turku +358-(0)-403000600
- GB** YASKAWA UK Ltd.
Banbury +44-1295-272755
- I** YASKAWA Italia s.r.l.
Torino +39-011-9005833
- IL** YASKAWA Europe Technology Ltd.
Rosh Ha'ayin +972-3-9004114
- NL** YASKAWA Benelux B.V.
EB Son +31-40-2895500
- RUS** YASKAWA Nordic AB
Moskva +46-480-417-800
- SE** YASKAWA Nordic AB
Torsås +46-480-417-800
- SI** YASKAWA Slovenia
Ribnica +386-1-8372-410
- TR** YASKAWA Turkey Elektrik Ticaret Ltd. Sti.
Istanbul +90-216-5273450
- ZA** YASKAWA Southern Africa (PTY) Ltd
Johannesburg +27-11-6083182

YASKAWA contacts

YASKAWA Europe GmbH Robotics Division
 Yaskawastraße 1
 D-65391 Allershausen
 Tel. +49 (0) 8166/90-0
 Fax +49 (0) 8166/90-103

YASKAWA academy and sales office Frankfurt

YASKAWA Europe GmbH Robotics Division
 Hauptstraße 185
 D-65760 Eschborn
 Tel. +49 (0) 6196/77725-0
 Fax +49 (0) 6196/77725-39

Distributors

- BG** Kammarton Bulgaria Ltd.
Sofia +359-02-926-6060
- CH** Messer Eutectic Castolin Switzerland S.A.
Dällikon +41-44-847-17-17
- DK** Robotcenter Danmark
Løsning +45 7022 2477
- EE** RKR Seadmed OÜ
Tallinn/Estonia +372-68-35-235
- GR** Gizelis Robotics
Nea Kifissia +30-2106251455
- H** Flexman Robotics Kft
Budapest +36-30-9510065
- LT** Profibus UAB
Panevezys +370-45-518575
- N** Optimove as
Lierstranda +47-32240600
- PL** Integrator RHC Sp. z o.o.
Torun +48-56-6519710
- PT** ROBOPLAN Lda
Aveiro +351-234 943 900
- RO** Sam Robotics srl
Timisoara +40-720-279-866
- RO** MPL Automation S.R.L.
Satu Mare +40 (0) 261 750 741

www.yaskawa.eu.com
robotics@yaskawa.eu.com

Controlled by NX100

The MOTOMAN EPX-series are versatile, high-speed 6 axis robots offering superior performance in painting applications for car bodies, plastic components and work pieces of different sizes. These robots feature a hollow wrist, which reduces cycle times and offers optimum accessibility. Furthermore, whilst the working envelope is relatively large, the installation only requires little space. In a smooth workflow even and smooth surfaces are produced with high speed and unique efficiency.

• Versatile, fast and flexible
• Perfect accessibility
• Large working range
• Variable payload
• Unique efficiency

MOTOMAN EPX-series

EPX1250 EPX2050 EPX2700 EPX2800 EPX2800R EPX2900

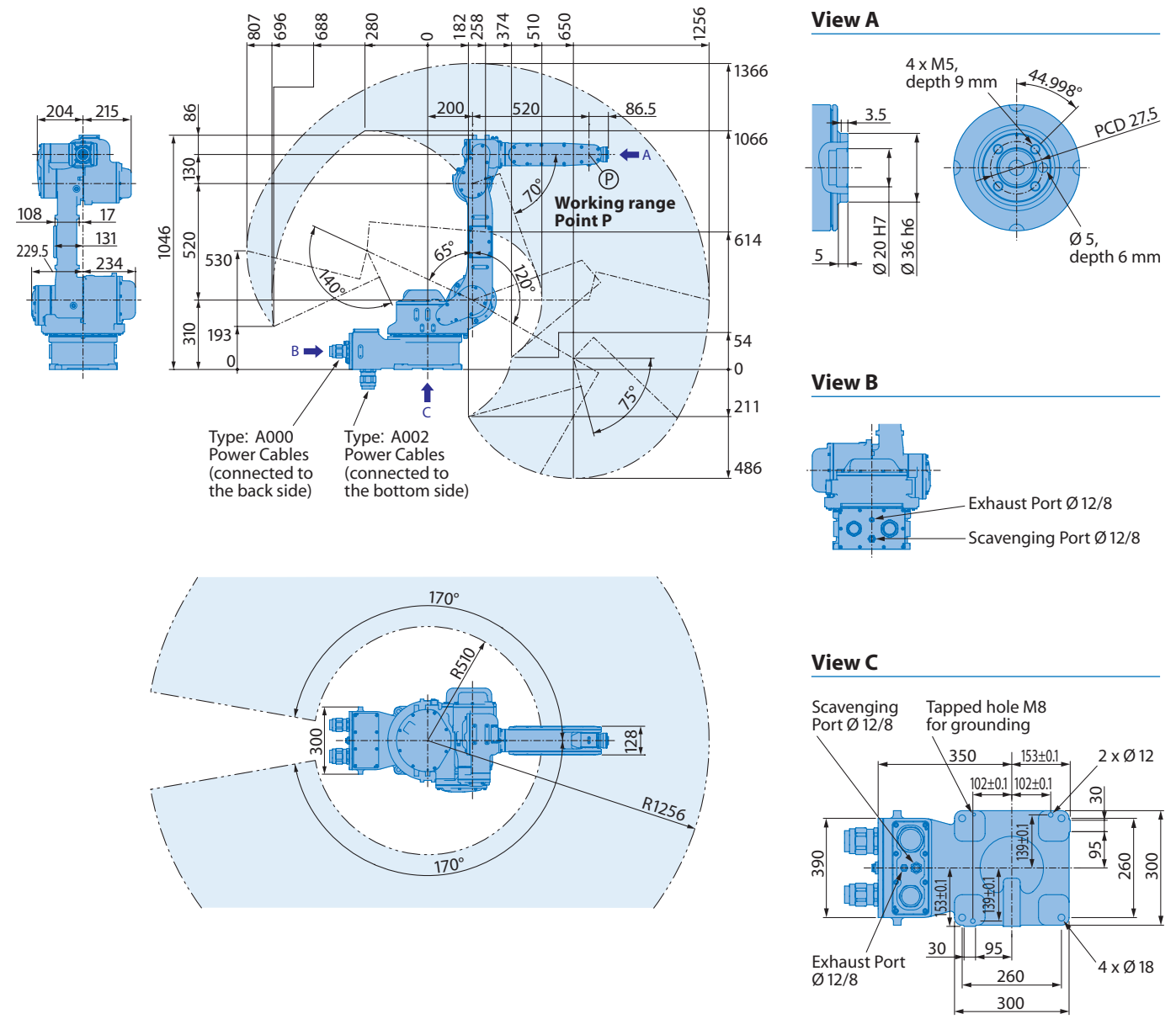

Protection level:
 II2G Ex px IIC T4 Gb
 II2D Ex p IIC T135°C Db IP66
 CE 0408

All dimensions in mm | Technical data may be subject to change without previous notice | Please request detailed drawings at robotics@yaskawa.eu.com - C-04-2014, A-No. 156797

Specifications EPX1250

Axes	Maximum motion range [°]	Maximum speed [°/sec.]	Allowable moment [Nm]	Allowable moment of inertia [kg · m ²]	Controlled axes	
S	±170	185	-	-	6	
L	+120/-65	185	-	-	5	
U	+205/-165	185	-	-	Max. payload [kg]	±0.15
R	±190	360	8	0.20	Max. working range [mm]	R = 1256
B	±145	410	8	0.20	Temperature [°C]	0 to +40
T	±360	500	3	0.07	Humidity [%]	20 - 80
					Weight [kg]	110
					Power supply, average [KVA]	1.5

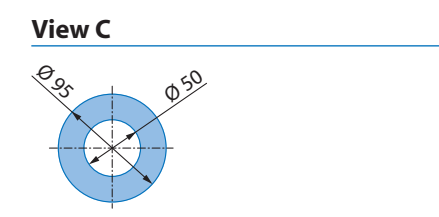
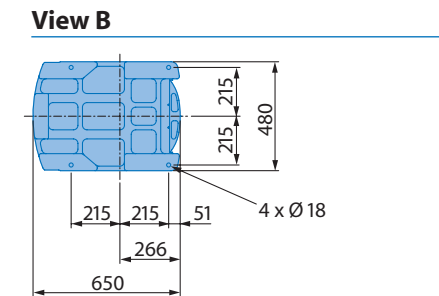
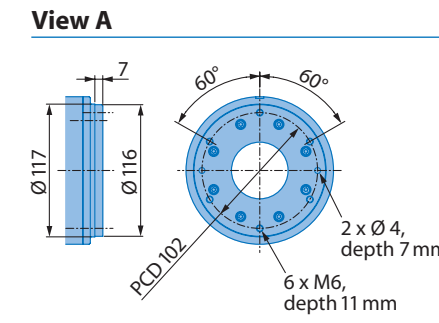
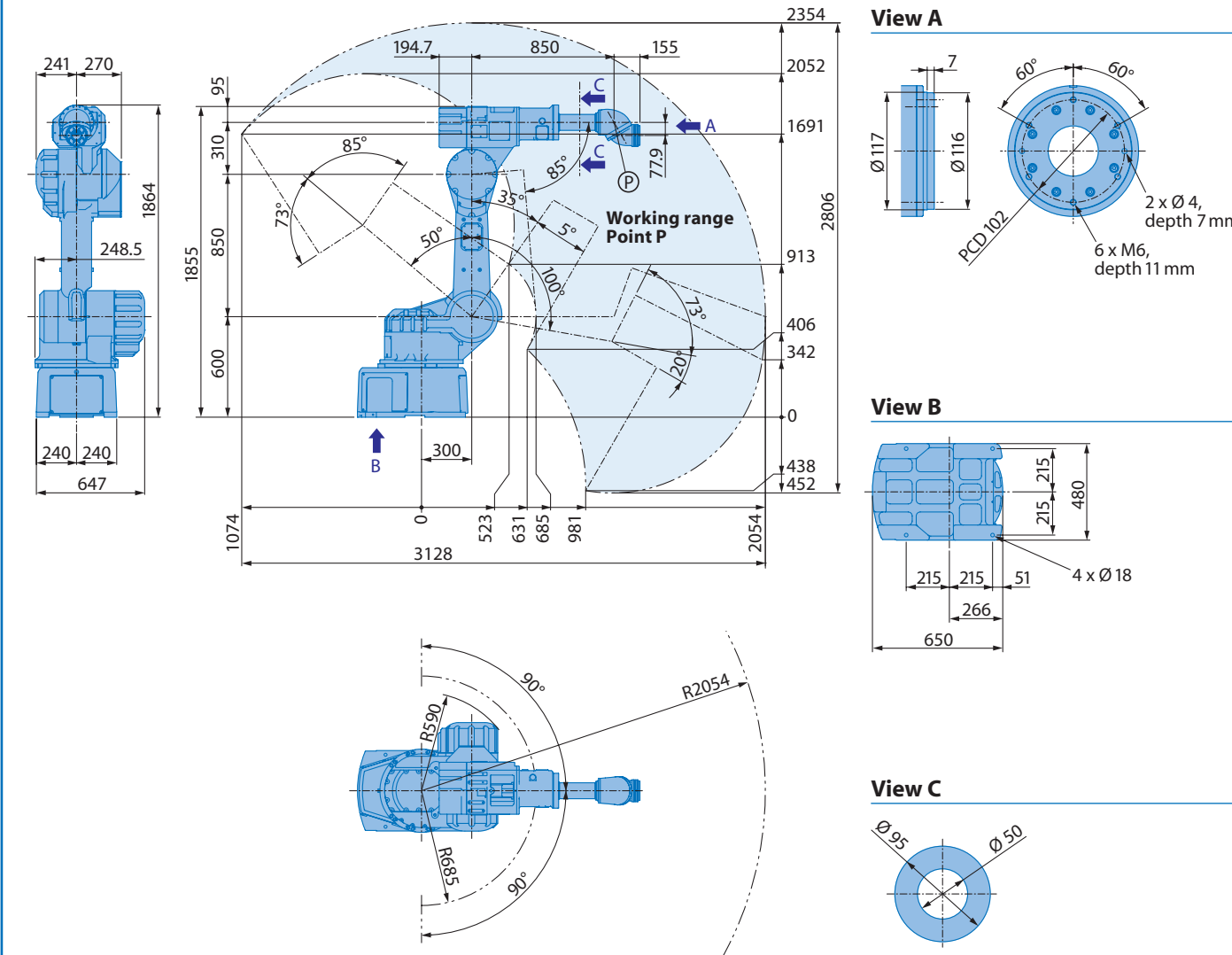

Mounting option: Floor

Protection level:
 Ex II2G Ex px II T4
 II2D Ex pD 21 IP66 Tmax 135°C
 CE 0408

All dimensions in mm | Technical data may be subject to change without previous notice | Please request detailed drawings at robotic@yaskawa.eu.com - C-04-2014, A-No. 156797

Specifications EPX2050						
Axes	Maximum motion range [°]	Maximum speed [m/sec.]	Allowable moment [Nm]	Allowable moment of inertia [kg · m ²]	Controlled axes	6
S	±90	2	–	–	Max. payload [kg]	15
L	+100/-50	is composite	–	–	Repeat.pos.accuracy [mm]	±0.5
U	+5/-163	speed	–	–	Max. working range [mm]	R = 2054
R	±360	of all axis	45.8	1.45	Temperature [°C]	0 to +45
B	±360	–	33.8	0.79	Humidity [%]	20 – 80
T	±360	–	10.8	0.10	Weight [kg]	540
					Power supply, average [KVA]	5

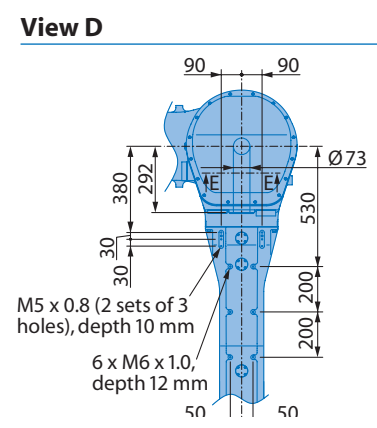
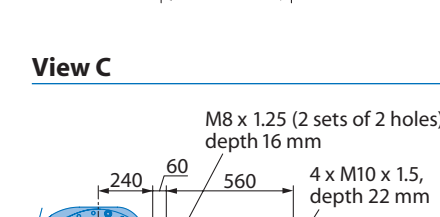
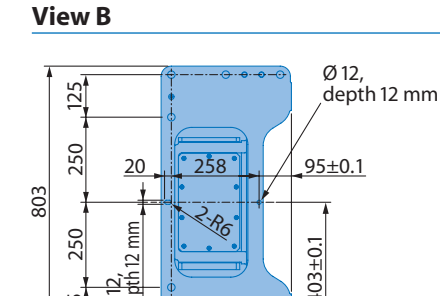
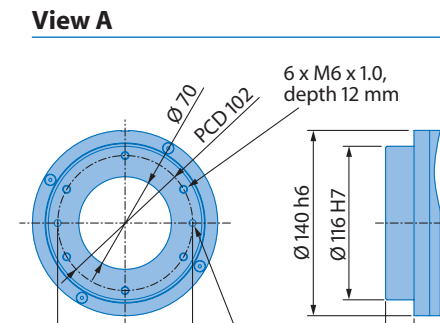
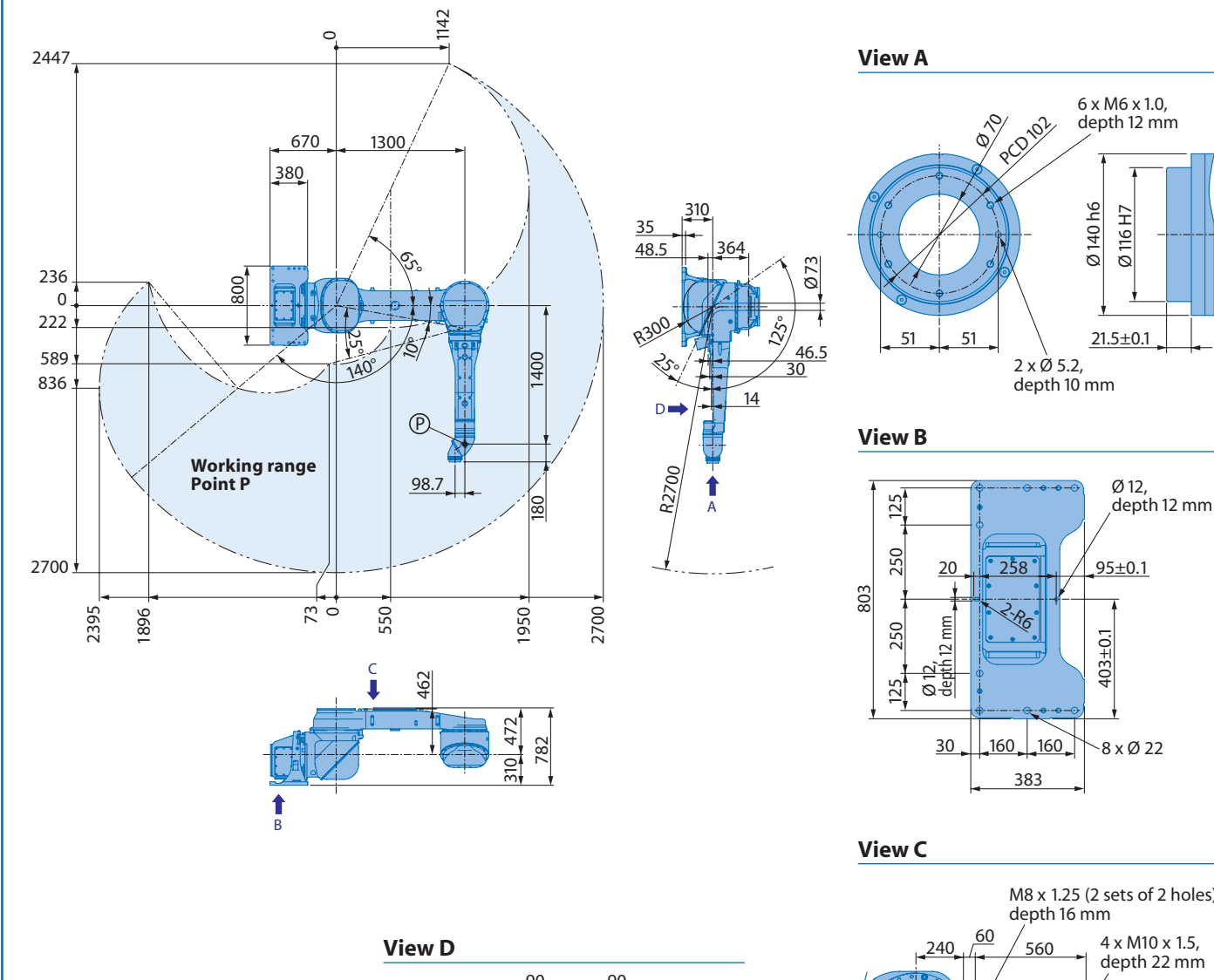

Protection level:
 Ex II2G Ex px IIC T4 Gb
 II2D Ex p IIC T135°C Db IP66
 CE 0408

All dimensions in mm | Technical data may be subject to change without previous notice | Please request detailed drawings at robotic@yaskawa.eu.com - C-04-2014, A-No. 156797

Specifications EPX2700						
Axes	Maximum motion range [°]	Maximum speed [m/sec.]	Allowable moment [Nm]	Allowable moment of inertia [kg · m ²]	Controlled axes	6
S	+125/-25	2	–	–	Max. payload [kg]	15
L	+140/-65	is composite	–	–	Repeat.pos.accuracy [mm]	±0.15
U	+90/-65	speed	–	–	Max. working range [mm]	R = 2700
R	±720	of all axis	45.8	1.45	Temperature [°C]	0 to +40
B	±720	–	33.8	0.79	Humidity [%]	20 – 80
T	±720	–	10.8	0.10	Weight [kg]	590
					Power supply, average [KVA]	5

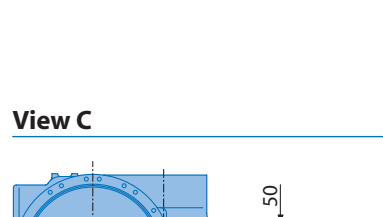
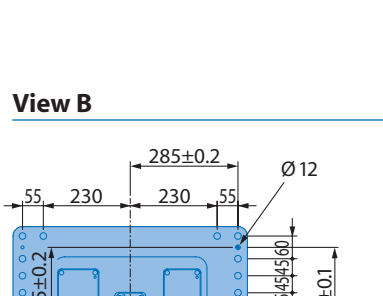
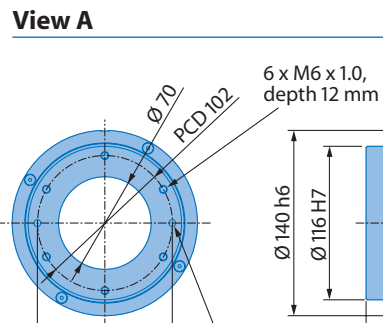
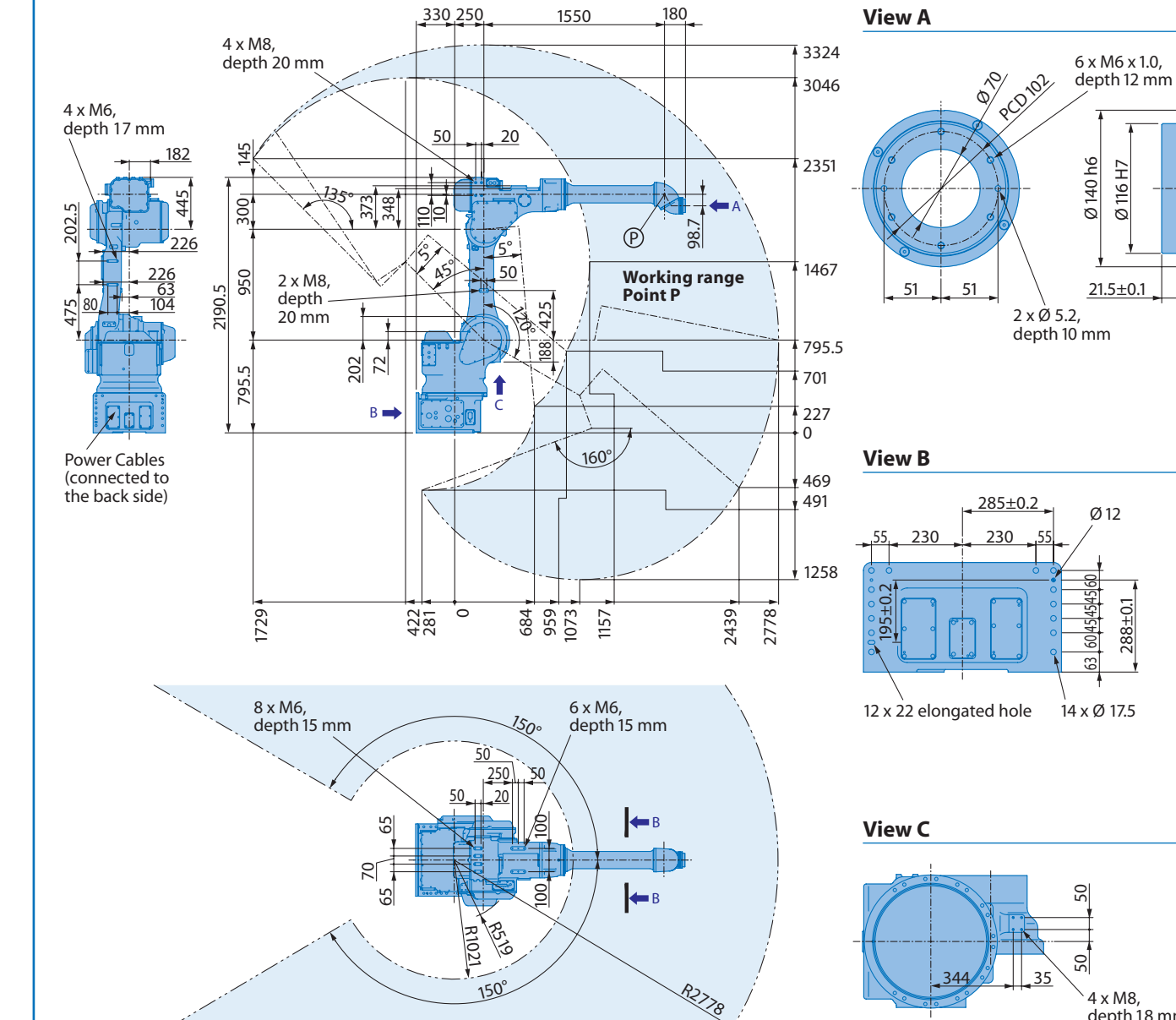

Mounting option: Floor

Protection level:
 Ex II2G Ex px IIC T4 Gb
 II2D Ex p IIC T135°C Db IP66
 CE 0408

All dimensions in mm | Technical data may be subject to change without previous notice | Please request detailed drawings at robotic@yaskawa.eu.com - C-04-2014, A-No. 156797

Specifications EPX2800						
Axes	Maximum motion range [°]	Maximum speed [m/sec.]	Allowable moment [Nm]	Allowable moment of inertia [kg · m ²]	Controlled axes	6
S	±150	2	–	–	Max. payload [kg]	20
L	+120/-45	is composite	–	–	Repeat.pos.accuracy [mm]	±0.5
U	+90/-85	speed	–	–	Max. working range [mm]	R = 2778
R	±360	of all axis	77.4	2.45	Temperature [°C]	0 to +40
B	±360	–	49.9	1.20	Humidity [%]	20 – 80
T	±360	–	16.6	0.20	Weight [kg]	650
					Power supply, average [KVA]	5

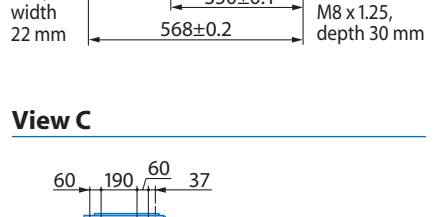
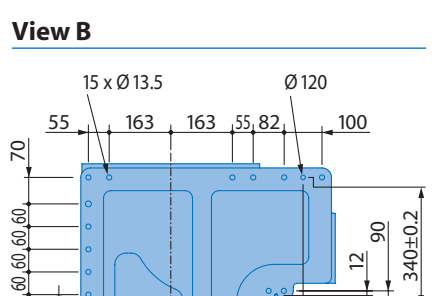
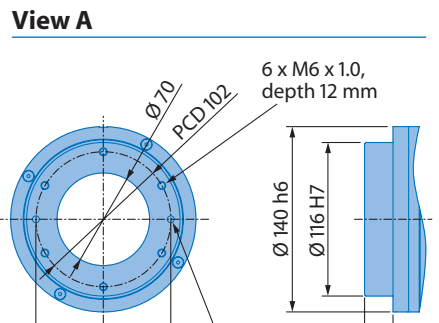
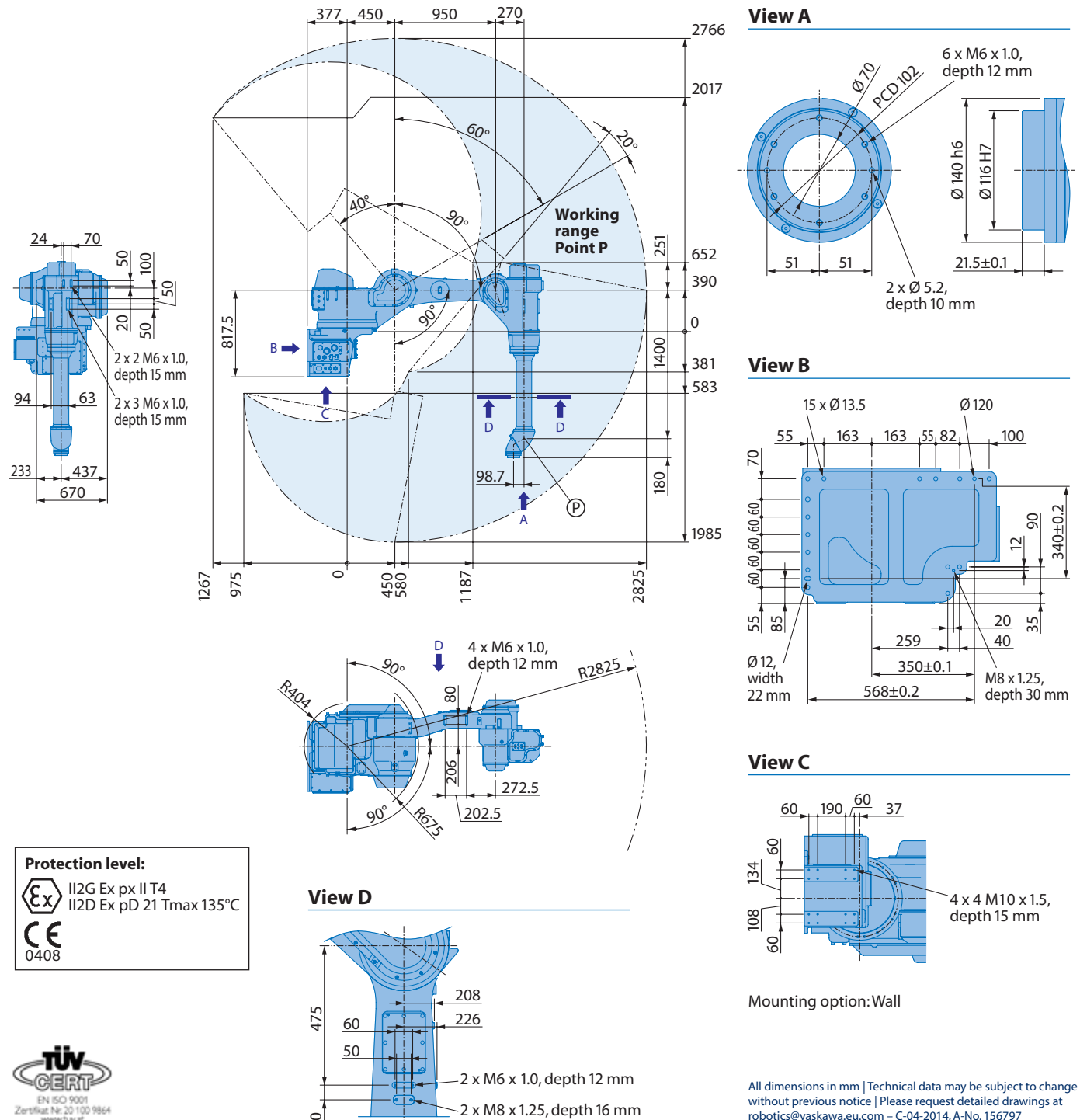

Mounting option: Wall

Protection level:
 Ex II2G Ex px II T4
 II2D Ex pD 21 Tmax 135°C
 CE 0408

All dimensions in mm | Technical data may be subject to change without previous notice | Please request detailed drawings at robotic@yaskawa.eu.com - C-04-2014, A-No. 156797

Specifications EPX2800R						
Axes	Maximum motion range [°]	Maximum speed [m/sec.]	Allowable moment [Nm]	Allowable moment of inertia [kg · m ²]	Controlled axes	6
S	±120	2	–	–	Max. payload [kg]	15
L	+90/-130	is composite	–	–	Repeat.pos.accuracy [mm]	±0.5
U	+90/-70	speed	–	–	Max. working range [mm]	R = 2825
R	±360	of all axis	45.8	1.45	Temperature [°C]	0 to +45
B	±360	–	33.8	0.79	Humidity [%]	20 – 80
T	±360	–	10.8	0.10	Weight [kg]	820
					Power supply, average [KVA]	5