

MOTOMAN HP20F-CR

Handling & General Applications
with the HP-series



Handling in cleanrooms

The high-speed, 6-axis MOTOMAN HP20F-CR robot offers superior performance in a variety of applications. This robot is specifically suited for use in a clean room, rated with ISO class 6.

The compact HP20F-CR requires minimal installation space, and offers improved part accessibility and the widest work envelope in its class.

This robot is driven by the compact FS100 controller.

KEY BENEFITS

- ISO class 6 (ISO 14644-1), clean room rated
- Increase productivity due to high speed motion
- Ideal for a variety of applications, multi-purpose robot
- Improved part accessibility
- A robust and rigid robot with increased inertia



Controlled by
FS100

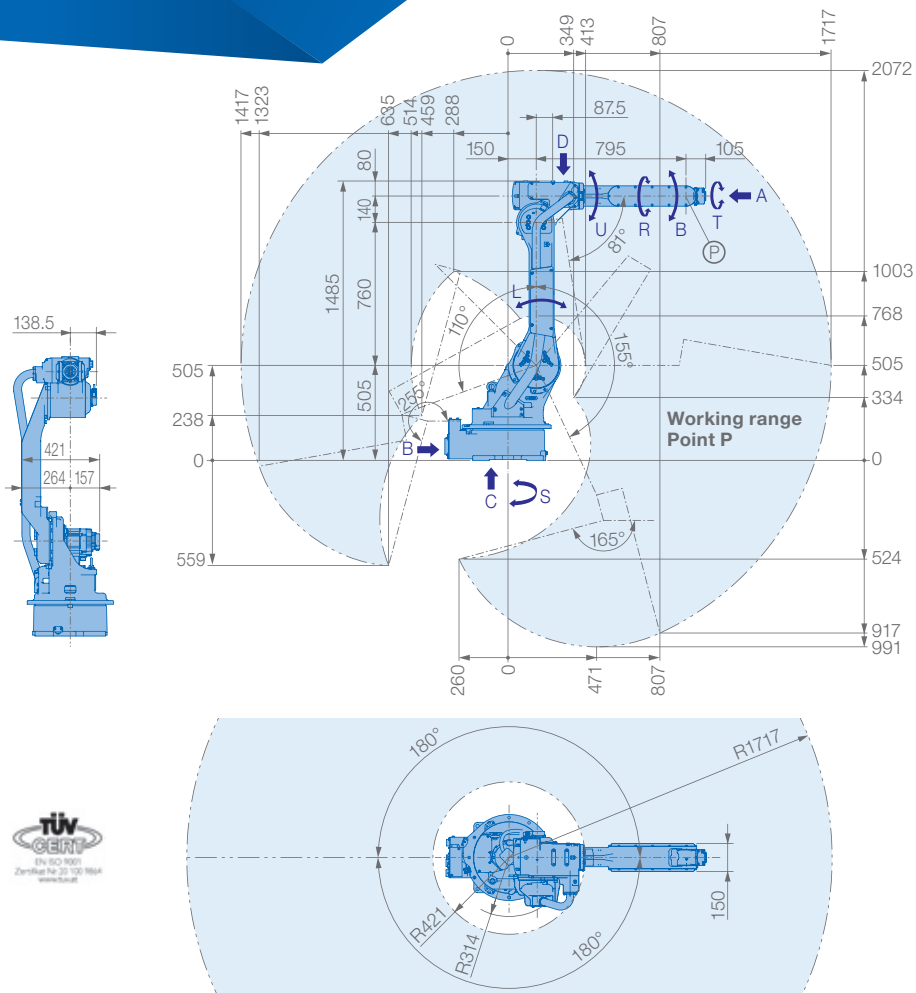

View A

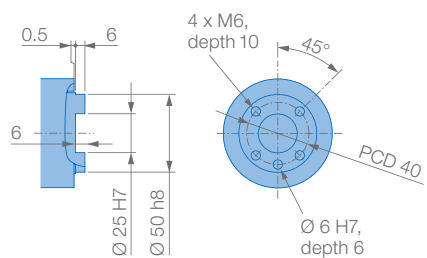

View B

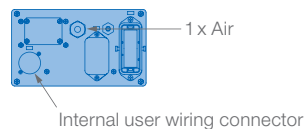

View C

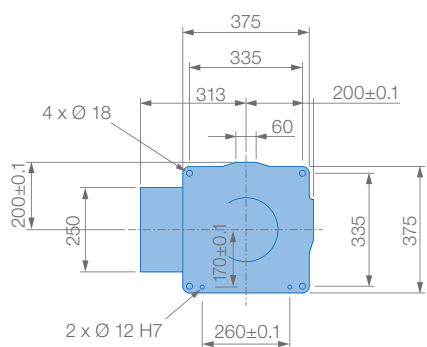

Mounting options: Floor, ceiling, wall
Protection class: IP54/67

View D

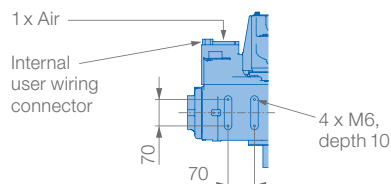

Allowable wrist load

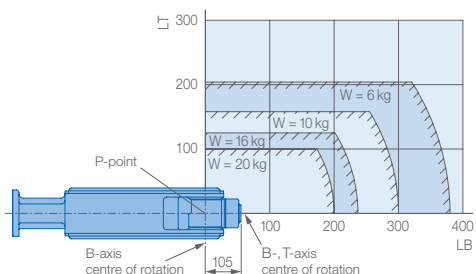

Allowable load on U-axis

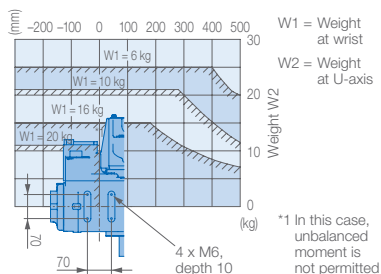

Specifications HP20F-CR						
Axes	Maximum motion range [°]	Maximum speed [°/sec.]	Allowable moment [Nm]	Allowable moment of inertia [kg · m ²]	Controlled axes	6
S	±180	197	-	-	Max. payload [kg]	20
L	+155/-110	175	-	-	Repeatability [mm]	±0.06
U	+255/-165	187	-	-	Max. working range R [mm]	1717
R	±200	400	39.2	1.05	Temperature [°C]	0 to +45
B	+230/-50	400	39.2	1.05	Humidity [%]	20 - 80
T	±360	600	19.6	0.75	Weight [kg]	268
					Power supply, average [KVA]	2.0